

RL303 ENERGY SAVING

Product details

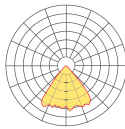
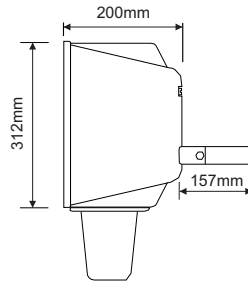
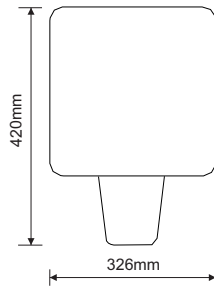

90°

Features

- Corrosion resistant glass reinforced polyester housing.
- Heat tempered glass.
- Integral control gear.
- High purity aluminium reflector.

Benefits

- Universal electroplated mounting stirrup with pole clamp.
- Ingress protection rating - IP 65.
- Black or white color options.

Applications

Security
Signage
Work areas
Illumination of buildings

Warranty

Reeflite glass reinforced polyester (GRP) housings are guaranteed for 15 years against deterioration due to ultra-violet radiation, hail damage and corrosion at coastal areas.

RL303 ENERGY SAVING

Specifications

Product Code	RL30385CFL	RL303105CFL
Approx System Wattage	85W CFL - E40	105W CFL - E40
Absolute Lumens	5100lm	6000lm
Colour Temperature	6500K	6500K
CRI	≥70	≥70
Life Span	TBA	TBA
Average temp	min -20° max +35°	min -20° max +35°
Housing Material	Fibreglass	Fibreglass
Packaging Weights and dimensions	437mm x 279mm x 317mm @ 3.5Kg	437mm x 279mm x 317mm @ 3.5Kg
Beam Angle	90°	90°
IP Rating	IP 65	IP 65
Power Factor	0.95	0.95
Starting /Running Amp	0.6 A - 0.38 A	0.9 A - 0.44 A
Suggested mounting height	3 - 5m Max	3 - 5m Max