

FDP Series

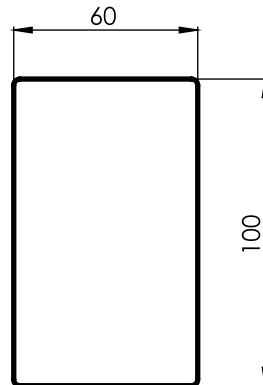

REFERENCE

LAMPS

LENGTH

FDP 20-1	1X20W	619
FDP 40-1	1X40W	1227
FDP 65-1	1X65W	1528

Single tube fittings available in 600mm (2'), 1200mm (4') and 1500mm (5') nominal lengths.

Body and ends manufactured from cold rolled steel, hot dip zinc phosphated and finished in a baked, high gloss, white epoxy polyester powder coat.

Wrap around acrylic diffuser has raised, square-based prisms for controlled light distribution and reduction of visible glare.

20mm Ø conduit back entry in centre.

Supply voltage 230V 50Hz.

S.A.B.S. approved.

Available in Electronic or Switch Start control gear.

Ordering data & main dimensions (mm).